

LET'S
LOOK
AT
ART
a family fun guide

Let's begin...start at the garden, located just outside the main entrance of the museum.

LISTEN

stand at these three places! what do you hear? is it different in each spot?

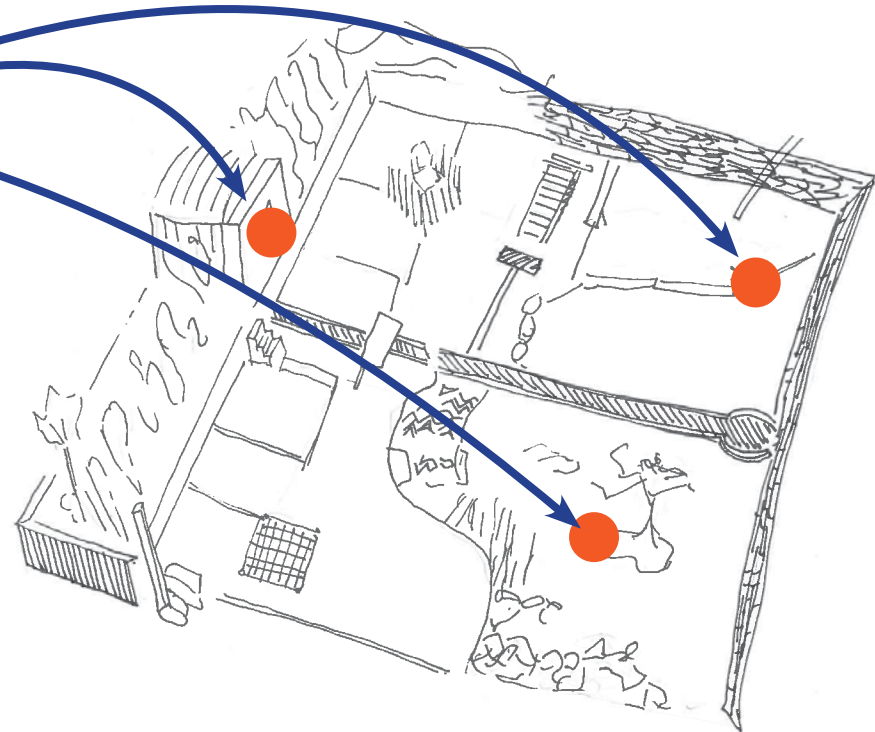

create a rubbing!

can you find this in the
garden? use the side
of a crayon to make a
rubbing of the texture!



how many different textures can you see
in the garden?

_____ (enter the number here)

Let's now head to the 4th floor, to check out Sarah Oppenheimer's piece. (You may need to ask the front desk for a key!)

why would
a piece of
art be kept
in a locked
room?



Cut out a view finder!

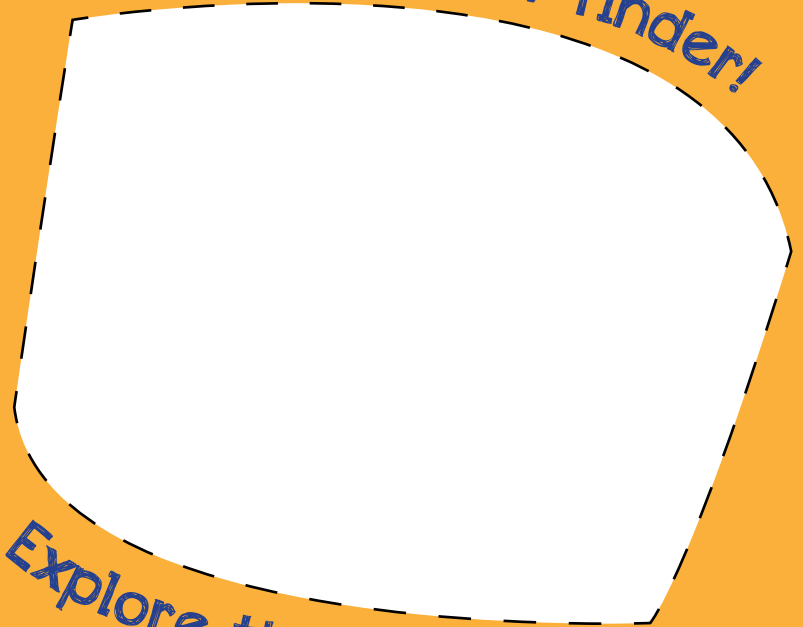

Explore the world!



What do you see with your view finder?

Remember to find the rest of Sarah's artwork on the 3rd floor!

Let's now head to the 3rd floor, to check out Yayoi Kusama's pieces!

PATTERNS

What happens when you cover something with a pattern?

Can you draw examples of patterns?

Two empty rectangular boxes with orange outlines, intended for drawing examples of patterns.

Add a pattern to these objects!

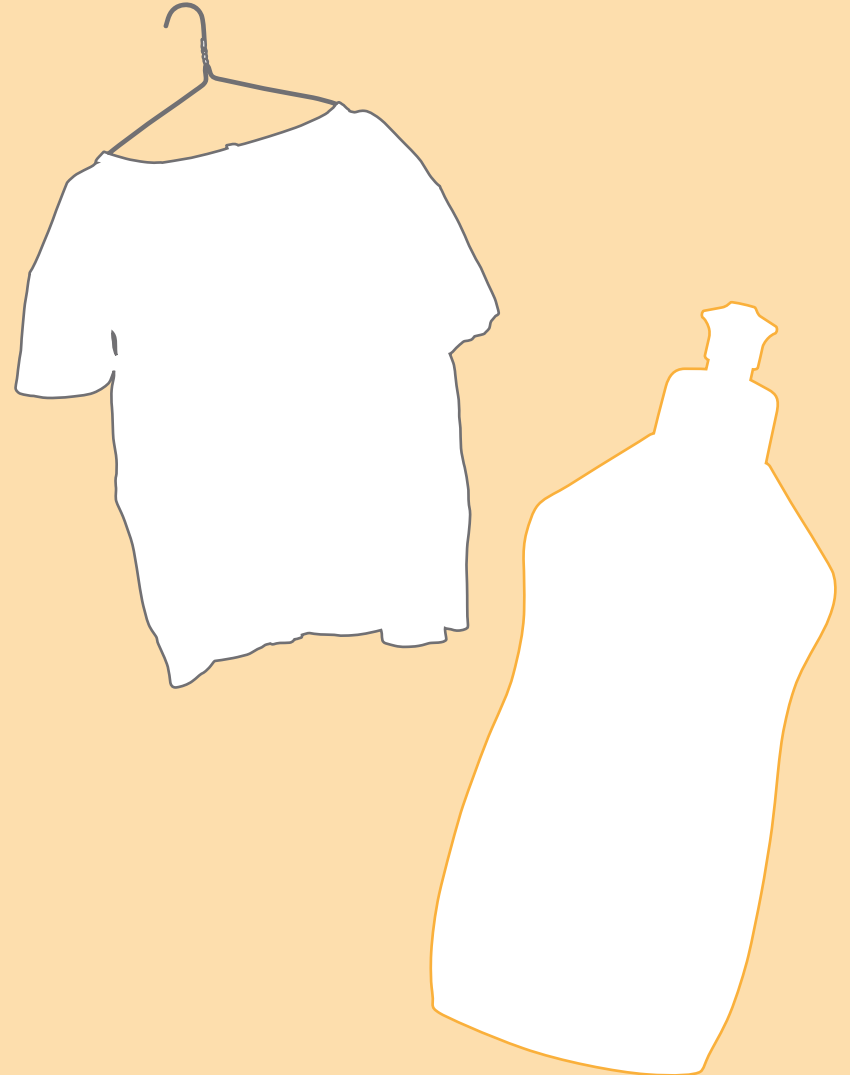

If you made a piece of artwork that
filled a **WHOLE** room, what would it look like?

Draw your imagination here!

Head to the second floor to check out the James Turrell art pieces. Are you ready to have fun with light?

Visit Danaë!
Stand back
What do you think?



then go close up
Is it what
you expected?

Visit Catso, Red

What do you think?
what shape does the light make?
did you ever think that art
could be made of light?

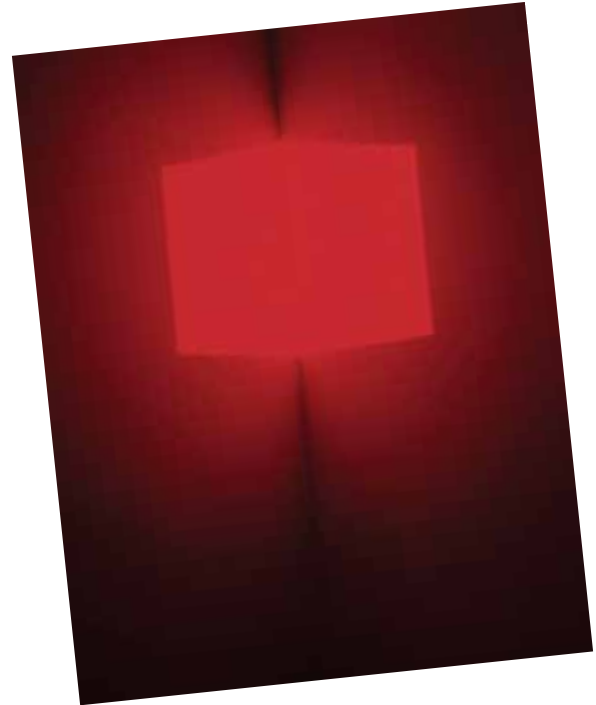

Come and visit again soon!



Mattress Factory

500 Sampsonia Way, Pittsburgh, PA 15212 | 412.231.3169

Check out www.mattress.org for more education programs or events.